

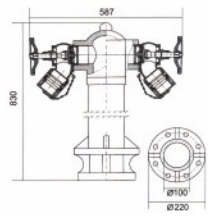

**TH 15-02-00**



INLET	OUTLET	TEST PRESSURE
100mm	2 1/2" BS336x2	350PSI 25BAR
WEIGHT		MATERIAL
60Kg		BOOY: CAST IRON BS1452 ADAPTOR: BRASS OR BRONZE



**TH15-02A-00**

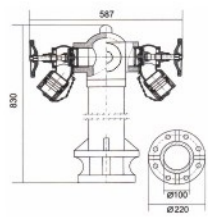

INLET	OUTLET	TEST PRESSURE
150mm	2 1/2" ~4"	350PSI 25BAR
WEIGHT		MATERIAL
80Kg		BOOY: CAST IRON BS1452 ADAPTOR: BRASS OR BRONZE



**TH 15-03-00**

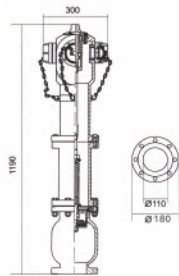

INLET	OUTLET	TEST PRESSURE
80~100mm	1 1/2" ~4"	350PSI 25BAR
WEIGHT		MATERIAL
80Kg		BOOY: CAST IRON BS1452 ADAPTOR: BRASS OR BRONZE



**TH15-12-00 (DN100)  
TH15-12A-00(DN80)**

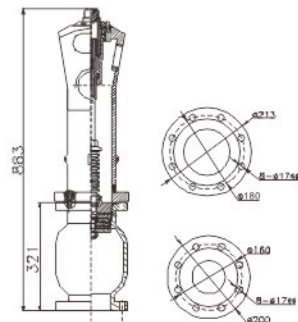

INLET	OUTLET	TEST PRESSURE
80~100mm	1 1/2" ~4"	350PSI 25BAR
WEIGHT		MATERIAL
61KG		BOOY: CAST IRON BS1452 ADAPTOR: BRASS OR BRONZE



**TH 15-04-00**

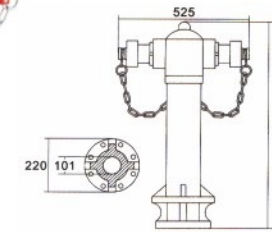

INLET	OUTLET	TEST PRESSURE
100mm	2 1/2" X2	350PSI 25BAR
WEIGHT		MATERIAL
60Kg		BOOY: CAST IRON BS1452 ADAPTOR: BRASS OR BRONZE



**TH 15-05-00**

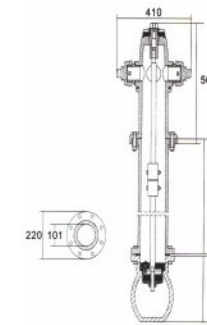

INLET	OUTLET	TEST PRESSURE
100mm	65mmx2 NST MALE 100mmx1 BSP MALE	350PSI 25BAR
WEIGHT		MATERIAL
150Kg		BOOY: CAST IRON BS1452 ADAPTOR: BRASS OR BRONZE



**TH 15-06-00**

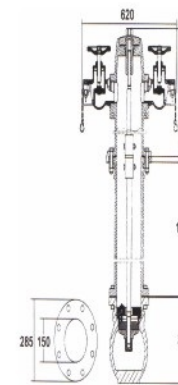

INLET	OUTLET	TEST PRESSURE
150mm	65mmx2 NST MALE 100mmx1 BSP MALE	350PSI 25BAR
WEIGHT		MATERIAL
180Kg		BOOY: CAST IRON BS1452 ADAPTOR: BRASS OR BRONZE



TH 15-07-00(L=1000mm)  
TH 15-07A-00(L=630mm)

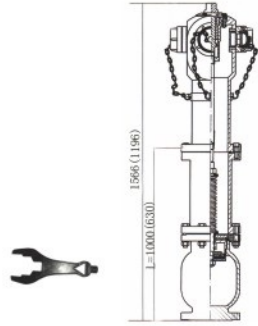

INLET	OUTLET	TEST PRESSURE
80~100mm	1 1/2" ~4"	350PSI 25BAR
WEIGHT		MATERIAL
81Kg		BOOY: CAST IRON BS1452 ADAPTOR: BRASS OR BRONZE

TH15-16-00



INLET	OUTLET	TEST PRESSURE
150MM	2 1/2" ~4"	350PSI 25BAR
WEIGHT		MATERIAL
50KG		BOOY: CAST IRON BS1452 ADAPTOR: BRASS OR BRONZE



Model No.	Inlet	Outlet	WORKING PRESSURE	WEIGHT
A:TH 15-09-00	φ70.1x2	2.5" BS336	25BAR	3.2Kg
B:TH 15-10-00	φ70.1x2	2.5" BS336	25BAR	4.3Kg
C:TH 15-11-00				
D:TH15-17-00				

TH15-13-00

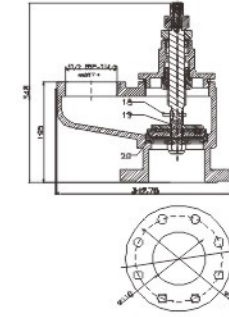

INLET	OUTLET	TEST PRESSURE
DN100	3 1/2" ~4"	25BAR
WEIGHT		MATERIAL
22KG		BOOY:CAST IRON BS1452 ADAPTOR:BRASS OR BRONZE

TH15-14-00

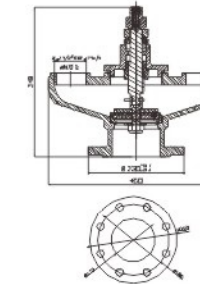

INLET	OUTLET	TEST PRESSURE
DN100	2 1/2"x2	25BAR
WEIGHT		MATERIAL
25KG		BOOY:CAST IRON BS1452 ADAPTOR:BRASS OR BRONZE

TH15-15-00

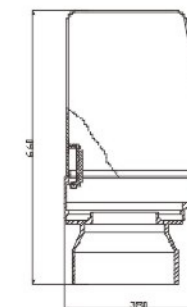

WIGHT	SIZE
20KG	380X350X660
21KG	400X380X600